

## 叉形预绝缘端头(TU-JTK型)

## SPADE VINYL-INSULATED TERMINAL(TYPE TU-JTK)

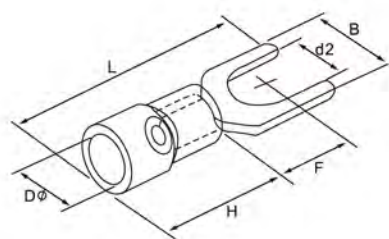

■ Conductor section:0.5-1.5mm<sup>2</sup>(A.W.G22~16) I<sub>max</sub>=19A Material:Copper Thickness:0.7mm

ITEM NO.	American Bolt number	d2 φ (mm)	Dimension(mm)					Color
			B	L	F	H	D φ	
SV 1.25-3	#4	3.2	5.7	21.6	6.5	10	4.3	Red
SVS 1.25-3.5	#6	3.7	5.7	21.6	6.5	10		
SVL 1.25-3.5	#6	3.7	6.4	21.2	6.5	10		
SVS 1.25-4	#8	4.3	8.0	21.2	6.5	10		
SVM 1.25-4	#8	4.3	7.2	21.2	6.5	10		
SVL 1.25-4	#8	4.3	8.1	21.2	6.5	10		
SVS 1.25-5	#10	5.3	8.1	21.2	6.5	10		
SVL 1.25-5	#10	5.3	9.5	21.2	6.5	10		
SVS 1.25-6	1/4	6.4	9.5	21.2	6.5	10		
SVL 1.25-6	1/4	6.4	12.0	27.2	11.0	10		



■ Conductor section:0.5-1.5mm<sup>2</sup>(A.W.G16~14) I<sub>max</sub>=27A Material:Copper Thickness:0.8mm

ITEM NO.	American Bolt number	d2 φ (mm)	Dimension(mm)					Color
			B	L	F	H	D φ	
SV 2-3	#4	3.2	5.7	21.6	6.5	10.6	4.9	Blue
SVS 2-3.5	#6	3.7	5.7	21.2	6.5			
SVL 2-3.5	#6	3.7	6.0	21.2	6.5			
SVS 2-4	#8	4.3	6.4	21.2	6.5			
SVM 2-4	#8	4.3	7.2	21.2	6.5			
SVL 2-4	#8	4.3	8.1	21.2	6.5			
SVS 2-5	#10	5.3	8.1	21.2	6.5			
SVL 2-5	#10	5.3	9.5	21.2	6.5			
SVS 2-6	1/4	6.4	9.5	21.2	6.5			
SVL 2-6	1/4	6.4	12.0	27.8	11.0			



■ Conductor section:2.5-4mm<sup>2</sup>(A.W.G14~12) I<sub>max</sub>=37A Material:Copper Thickness:1.0mm

ITEM NO.	American Bolt number	d2 φ (mm)	Dimension(mm)					Color
			B	L	F	H	D φ	
SV 3.5-3	#4	3.2	5.7	26.8	7.0	13.0	6.2	Black
SV 3.5-4	#8	4.3	8.0	24.8	7.0			
SV 3.5-5	#10	5.3	8.0	24.8	7.0			
SV 3.5-6	1/4	6.4	12.1	28.3	12.1			



■ Conductor section:4-6mm<sup>2</sup>(A.W.G12~10) I<sub>max</sub>=48A Material:Copper Thickness:1.0mm

ITEM NO.	American Bolt number	d2 φ (mm)	Dimension(mm)					Color
			B	L	F	H	D φ	
SV 5.5-3.5	#6	3.7	8.4	26	7.5	13.0	6.7	Yellow
SVS 5.5-4	#8	4.3	8.4	26	7.5			
SVL 5.5-4	#8	4.3	9.0	26	7.5			
SV 5.5-5	#10	5.3	9.0	26	7.5			
SVS 5.5-6	1/4	6.4	9.0	26	7.5			
SVL 5.5-6	1/4	6.4	12.0	32	12.0			
SV 5.5-8	5/16	8.4	14.0	31	11.5			



叉形裸端头(TU型)

**SPADE NON-INSULATED TERMINAL(TYPE TU)**

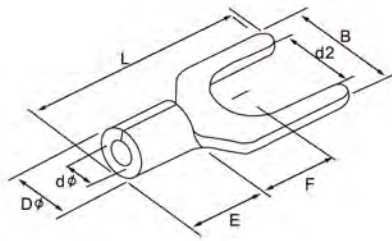

■ Conductor section:0.5~1.5mm<sup>2</sup>(A.W.G22~16)1max=19A Material:Copper Thickness:0.7mm

ITEM NO.	American Bolt number	d2 φ (mm)	Dimension(mm)					
			B	L	F	E	D φ	d φ
SNB 1.25-3	#4	3.2	5.7	16.0	6.5	4.8	3.4	1.7
SNBS 1.25-3.5	#6	3.7	5.7	16.0	6.5			
SNBL 1.25-3.5	#6	3.7	6.4	15.5	6.5			
SNBS 1.25-4	#8	4.3	6.4	15.5	6.5			
SNBM 1.25-4	#8	4.3	7.2	15.5	6.5			
SNBL 1.25-4	#8	4.3	8.1	15.5	6.5			
SNBS 1.25-5	#10	5.3	8.1	15.5	6.5			
SNBL 1.25-5	#10	5.3	9.5	15.5	6.5			
SNBS 1.25-6	1/4	6.4	9.5	15.5	6.5			
SNBL 1.25-6	1/4	6.4	12.0	22.0	11.0			

■ Conductor section:1.5~2.5mm<sup>2</sup>(A.W.G16~14)1max=27A Material:Copper Thickness:0.8mm

ITEM NO.	American Bolt number	d2 φ (mm)	Dimension(mm)					
			B	L	F	E	D φ	d φ
SNB 2-3	#4	3.2	5.7	16.0	6.5	4.8	4.1	2.3
SNBS 2-3.5	#6	3.7	5.7	16.0	6.5			
SNBL 2-3.5	#6	3.7	6.0	16.0	6.5			
SNBS 2-4	#8	4.3	6.4	16.0	6.5			
SNBM 2-4	#8	4.3	7.2	16.0	6.5			
SNBL 2-4	#8	4.3	8.1	16.0	6.5			
SNBS 2-5	#10	5.3	8.1	16.0	6.5			
SNBL 2-5	#10	5.3	9.5	16.0	6.5			
SNBS 2-6	1/4	6.4	9.5	16.0	6.5			
SNBL 2-6	1/4	6.4	12.0	22.0	11.0			

■ Conductor section:2.5~4mm<sup>2</sup>(A.W.G14~12)1max=37A Material:Copper Thickness:1.0mm

ITEM NO.	American Bolt number	d2 φ (mm)	Dimension(mm)					
			B	L	F	E	D φ	d φ
SNB 3.5-3	#4	3.2	5.7	18.3	7.0	6.0	5.0	3.0
SNB 3.5-4	#8	4.3	8.0	18.3	7.0			
SNB 3.5-5	#10	5.3	8.0	18.3	7.0			
SNB 3.5-6	1/4	6.4	12.0	21.5	10.5			

■ Conductor section:4~6mm<sup>2</sup>(A.W.G12~10)1max=48A Material:Copper Thickness:1.0mm

ITEM NO.	American Bolt number	d2 φ (mm)	Dimension(mm)					
			B	L	F	E	D φ	d φ
SNB 5.5-3.5	#6	3.7	8.3	19.5	7.2	6.8	5.6	3.4
SNBS 5.5-4	#8	4.3	8.3	19.5	7.2			
SNBL 5.5-4	#8	4.3	9.0	19.5	7.5			
SNB 5.5-5	#10	5.3	9.0	19.5	7.5			
SNBS 5.5-6	1/4	6.4	9.0	19.5	7.2			
SNBL 5.5-6	1/4	6.4	12.0	25.5	12.0			
SNB 5.5-8	5/16	8.4	14.0	24.5	11.5			

■ Material:Copper Thickness:1.2mm、1.4mm、1.7mm

ITEM NO.	American Bolt number	d2 φ (mm)	Dimension(mm)					
			B	L	F	E	D φ	d φ
SNB 8-4	#8	4.3	8.7	23.0	6.0	8.5	7.2	4.5
SNB 8-5	#10	5.3	12.0	24.5	5.7	8.5	7.2	4.5
SNB 8-6	1/4	6.4	12.0	24.5	5.7	8.5	7.2	4.5
SNB 8-8	5/16	8.4	14.5	28.0	8.3	8.5	7.2	4.5
SNB 14-6	1/4	6.4	12.0	28.0	7.5	10.5	9.0	5.8
SNB 14-8	5/16	8.4	14.0	28.0	7.5	10.5	9.0	5.8
SNB 22-8	5/16	8.4	14.0	34.5	9.0	12.0	11.5	7.7

## 圆形预绝缘端头(TO-JTK型)

## RING VINYL-INSULATED TERMINAL(TYPE TO-JTK)

■ Conductor section:0.5-1.5mm<sup>2</sup>(A.W.G22~16) I<sub>max</sub>=19A Material:Copper Thickness:0.7mm

ITEM NO.	American Bolt number	d2 φ (mm)	Dimension(mm)					Color
			B	L	F	H	D φ	
RV 1.25-3	#4	3.2	5.7	18.7	4.95	10.6	4.3	Red
RVS 1.25-3.5	#6	3.7	5.7	18.7	4.95			
RVM 1.25-3.5	#6	3.7	6.6	19.4	6.3			
RVL 1.25-3.5	#6	3.7	8.0	21.2	7.0			
RVS 1.25-4	#8	4.3	6.6	19.4	6.3			
RVL 1.25-4	#8	4.3	8.0	21.2	7.0			
RVS 1.25-5	#10	5.3	8.0	21.2	7.0			
RVL 1.25-5	#10	5.3	9.8	23	8.5			
RVS 1.25-6	1/4	6.4	9.8	23	8.5			
RVL 1.25-6	1/4	6.4	11.6	26.8	11.1			
RV 1.25-8	5/16	8.4	11.6	27.4	11.1			
RV 1.25-10	3/8	10.5	13.6	27.4	13.9			
RV 1.25-12	1/2	13.0	19.2	37.3	16.5			

■ Conductor section:0.5-2.5mm<sup>2</sup>(A.W.G16~14) I<sub>max</sub>=27A Material:Copper Thickness:0.8mm



ITEM NO.	American Bolt number	d2 φ (mm)	Dimension(mm)					Color
			B	L	F	H	D φ	
RV 2-3	#4	3.2	6.6	17.5	4.3	10.6	4.9	Blue
RVS 2-3.5	#6	3.7	6.6	17.5	4.3			
RVM 2-3.5	#8	3.7	6.6	20	6.2			
RVL 2-3.5	#6	3.7	8.5	22.8	7.75			
RVS 2-4	#8	4.3	6.6	20	6.2			
RVL 2-4	#8	4.3	8.5	22.8	7.75			
RVS 2-5	#10	5.3	8.5	22	7.75			
RVL 2-5	#10	5.3	9.5	22.6	7.25			
RVS 2-6	1/4	6.4	11.9	27.2	11.0			
RV 2-8	5/16	8.4	11.9	27.2	11.0			
RV 2-10	3/8	10.5	13.6	31.1	13.9			
RV 2-12	1/2	13.0	19.2	36.8	16.5			

■ Conductor section:2.5-4mm<sup>2</sup>(A.W.G14~12) I<sub>max</sub>=37A Material:Copper Thickness:1.0mm



ITEM NO.	American Bolt number	d2 φ (mm)	Dimension(mm)					Color
			B	L	F	H	D φ	
RV 3.5-4	#8	4.3	8.0	24.5	7.7	13.5	6.2	Black
RVS 3.5-5	#10	5.3	8.0	24.5	7.7			
RVL 3.5-5	#10	5.3	12.0	29	7.7			
RV 3.5-6	1/4	6.4	12.0	29	7.7			

■ Conductor section:4-6mm<sup>2</sup>(A.W.G12~10) I<sub>max</sub>=48A Material:Copper Thickness:1.0mm

ITEM NO.	American Bolt number	d2 φ (mm)	Dimension(mm)					Color
			B	L	F	H	D φ	
RV 5.5-3.5	#6	3.7	7.2	22	5.3	13.5	6.7	Yellow
RVS 5.5-4	#8	4.3	7.2	22	5.3			
RVL 5.5-4	#8	4.3	9.5	26.2	8.25			
RV 5.5-5	#10	5.3	9.5	26.2	8.25			
RVS 5.5-6	1/4	6.4	12.0	32.1	10.7			
RVL 5.5-6	1/4	6.4	12.0	32.8	13			
RV 5.5-8	5/16	8.4	15.0	34	13.7			
RV 5.5-10	3/8	10.5	15.0	34	13.7			
RV 5.5-12	1/2	13.0	19.2	38.8	16			

圆形裸端头(TO型)

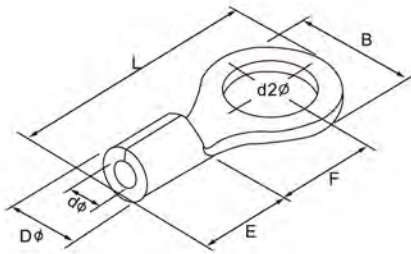
RING NON-INSULATED TERMINAL(TYPE TO)



■ Conductor section:0.5~1.5mm<sup>2</sup>(A.W.G22~16) 1max=19A Material:Copper Thickness:0.7mm

ITEM NO.	American Bolt number	d2 φ (mm)	Dimension(mm)					
			B	L	F	E	D φ	d φ
RNB 1.25-3	#4	3.2	5.7	12.6	4.95	4.8	3.4	1.7
RNBS 1.25-3.5	#6	3.7	5.7	12.6	4.95			
RNBM 1.25-3.5	#6	3.7	6.6	14.4	6.3			
RNBL 1.25-3.5	#6	3.7	8.0	15.8	7.0			
RNBS 1.25-4	#8	4.3	6.6	14.4	6.3			
RNBL 1.25-4	#8	4.3	8.0	15.8	7.0			
RNBS 1.25-5	#10	5.3	8.0	15.8	7.0			
RNBL 1.25-5	#10	5.3	9.8	18.0	8.3			
RNBS 1.25-6	1/4	6.4	9.8	18.8	8.3			
RNBL 1.25-6	1/4	6.4	11.6	21.8	11.2			
RNB 1.25-8	5/16	8.4	11.6	21.8	11.2			
RNB 1.25-10	3/8	10.5	13.6	25.5	13.9			
RNB 1.25-12	1/2	13.0	19.2	31.0	16.5			

■ Conductor section:1.5~2.5mm<sup>2</sup>(A.W.G16~14) 1max=27A Material:Copper Thickness:0.8mm

ITEM NO.	American Bolt number	d2 φ (mm)	Dimension(mm)					
			B	L	F	E	D φ	d φ
RNB 2-3	#4	3.2	6.6	12.3	4.2	4.8	4.1	2.3
RNBS 2-3.5	#6	3.7	6.6	12.3	4.2			
RNBM 2-3.5	#6	3.7	6.6	16.0	7.9			
RNBL 2-3.5	#6	3.7	8.5	16.8	7.75			
RNBS 2-4	#8	4.3	6.6	16.0	7.9			
RNBL 2-4	#8	4.3	8.5	16.8	7.75			
RNBS 2-5	#10	5.3	8.5	16.8	7.75			
RNBL 2-5	#10	5.3	9.5	16.8	7.25			
RNB 2-6	1/4	6.4	12.0	21.8	11.0			
RNB 2-8	5/16	6.4	12.0	21.8	11.0			
RNB 2-10	3/8	10.5	13.6	25.5	13.9			
RNB 2-12	1/2	13.0	19.2	31.0	16.5			

■ Conductor section:2.5~4mm<sup>2</sup>(A.W.G14~12) 1max=37A Material:Copper Thickness:1.0mm

ITEM NO.	American Bolt number	d2 φ (mm)	Dimension(mm)					
			B	L	F	E	D φ	d φ
RNB 3.5-4	#8	4.3	8.0	18.0	7.7	6.0	5.0	3.0
RNBS 3.5-5	#10	5.3	8.0	18.0	7.7			
RNBL 3.5-5	#10	5.3	12.0	21.4	7.7			
RNB 3.5-6	1/4	6.4	12.0	21.4	7.7			

■ Conductor section:4~6mm<sup>2</sup>(A.W.G12~10) 1max=48A Material:Copper Thickness:1.0mm

ITEM NO.	American Bolt number	d2 φ (mm)	Dimension(mm)					
			B	L	F	E	D φ	d φ
RNB 5.5-3.5	#6	3.7	7.2	15.7	5.3	6.8	5.6	3.4
RNBS 5.5-4	#8	4.3	7.2	15.7	5.3			
RNBL 5.5-4	#8	4.3	9.5	19.8	8.25			
RNB 5.5-5	#10	5.3	9.5	19.8	8.25			
RNBS 5.5-6	1/4	6.4	12.0	23.35	10.7			
RNBL 5.5-6	1/4	6.4	12.0	25.8	13.0			
BNB 5.5-8	5/16	8.4	15.0	28.0	13.7			
RNB 5.5-10	3/8	10.5	15.0	28.0	13.7			
RNB 5.5-12	1/2	13.0	19.2	32.4	16.0			

## 圆形裸端头(TO型)

## RING NON-INSULATED TERMINAL(TYPE TO)

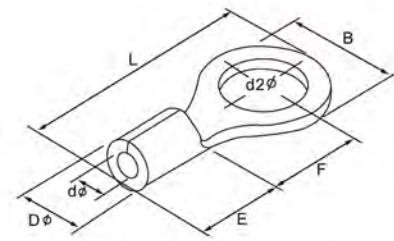

■ Conductor section: 6~10mm<sup>2</sup>(A.W.G8) 1max=62A Material:Copper Thickness:1.2mm

ITEM NO.	American Bolt number	d2 φ (mm)	Dimension(mm)					
			B	L	F	E	D φ	d φ
RNB 8-4	#8	4.3	8.8	23.8	9.3	8.5	7.2	4.5
RNBS 8-5	#10	5.3	8.8	23.8	11.1			
RNBM 8-5	#10	5.3	12.0	23.8	9.3			
RNBL 8-5	#10	5.3	15.0	29.8	13.8			
RNBS 8-6	1/4	6.4	12.0	23.8	9.3			
RNBL 8-6	1/4	6.4	15.0	29.8	13.8			
RNB 8-8	5/16	8.4	15.0	29.8	13.8			
RNB 8-10	3/8	10.5	15.0	29.8	13.8			
RNB 8-12	1/2	13.0	20.0	33.5	15.0			



■ Conductor section: 10~16mm<sup>2</sup>(A.W.G6) 1max=88A Material:Copper Thickness:1.4mm

ITEM NO.	American Bolt number	d2 φ (mm)	Dimension(mm)					
			B	L	F	E	D φ	d φ
RNB 14-4	#8	4.3	12.0	29.8	13.3	10.5	9.5	5.8
RNB 14-5	#10	5.3	12.0	29.8	13.3			
RNBS 14-6	1/4	6.4	12.0	29.8	13.3			
RNBL 14-6	1/4	6.4	16.0	32.8	13.3			
RNB 14-8	5/16	8.4	16.0	31.8	13.3			
RNB 14-10	3/8	10.5	16.0	31.8	13.3			
RNB 14-12	1/2	13.0	22.0	41.0	19.5			



■ Conductor section: 16-25mm<sup>2</sup>(A.W.G4) 1max=115A Material:Copper Thickness:1.8mm

ITEM NO.	American Bolt number	d2 φ (mm)	Dimension(mm)					
			B	L	F	E	D φ	d φ
RNBS 22-5	#10	4.3	12.2	33.2	15.1	12.0	11.5	7.7
RNBL 22-5	#10	5.3	16.5	33.7	13.5			
RNBS 22-6	1/4	6.4	12.2	33.2	15.1			
RNBL 22-6	1/4	6.4	16.5	33.7	13.5			
RNB 22-8	5/16	8.4	16.5	33.7	13.5			
RNB 22-10	3/8	10.5	16.5	33.7	13.5			
RNB 22-11	7/16	11.5	22.0	42.5	19.5			
RNB 22-12	1/2	13.0	22.0	42.5	19.5			

■ Conductor section: 35~50mm<sup>2</sup>(A.W.G2) 1max=160A Material:Copper Thickness:1.8mm

ITEM NO.	American Bolt number	d2 φ (mm)	Dimension(mm)					
			B	L	F	E	D φ	d φ
RNB 38-5	#10	5.3	15.3	39.0	17.4	14.0	13.3	9.4
RNB 38-6	1/4	6.4	15.3	39.0	17.4			
RNBS 38-8	5/16	8.4	15.3	39.0	17.4			
RNBL 38-8	5/16	8.4	22.0	42.7	17.7			
RNBS 38-10	3/8	10.5	15.3	39.0	17.4			
RNBL 38-10	3/8	10.5	22.0	42.7	17.7			
RNB 38-11	7/16	11.5	22.0	42.7	17.7			
RNB 38-12	1/2	13.0	22.0	42.7	17.7			

圆形裸端头(TO型)

RING NON-INSULATED TERMINAL(TYPE TO)

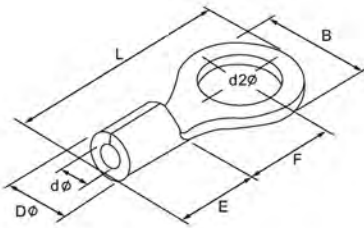

■ Conductor section:50~70mm<sup>2</sup>(A.W.G1/0) 1max=215A Material:Copper Thickness:1.8mm

ITEM NO.	American Bolt number	d2 φ (mm)	Dimension(mm)					
			B	L	F	E	D φ	d φ
RNB 60-6	1/4	6.4	22.0	49.7	20.7	18.0	15.4	11.4
RNB 60-8	5/16	8.4						
RNB 60-10	3/8	10.5						
RNB 60-11	7/16	11.5						
RNB 60-12	1/2	13.0						
RNB 60-14	9/16	15.0	32.0	57.5	23.5	18.0	15.4	11.4
RNB 60-16	5/8	17.0						
RNB 60-18	11/16	19.0						
RNB 60-20	3/4	21.0						
RNB 60-22	7/8	23.0						

■ Conductor section:70~95mm<sup>2</sup>(A.W.G2/0) 1max=235A Material:Copper Thickness:2.0mm

ITEM NO.	American Bolt number	d2 φ (mm)	Dimension(mm)					
			B	L	F	E	D φ	d φ
RNB 70-6	1/4	6.4	24.0	51.0	20.0	19.0	17.5	13.3
RNB 70-8	5/16	8.4						
RNB 70-10	3/8	10.5						
RNB 70-11	7/16	11.5						
RNB 70-12	1/2	13.0						
RNB 70-14	9/16	15.0	32.0	61.0	26.0	19.0	17.5	13.3
RNB 70-16	5/8	17.0						
RNB 70-18	11/16	19.0						
RNB 70-20	3/4	21.0						
RNB 70-22	7/8	23.0						

■ Conductor section:95~120mm<sup>2</sup>(A.W.G3/0) 1max=255A Material:Copper Thickness:2.2mm

ITEM NO.	American Bolt number	d2 φ (mm)	Dimension(mm)					
			B	L	F	E	D φ	d φ
RNB 80-6	1/4	6.4	27.0	54.2	20.7	20.0	19.5	14.5
RNB 80-8	5/16	8.4						
RNB 80-10	3/8	10.5						
RNB 80-11	7/16	11.5						
RNB 80-12	1/2	13.0						
RNB 80-14	9/16	15.0	32.0	68.0	32.0	20.0	19.5	14.5
RNB 80-16	5/8	17.0						
RNB 80-18	11/16	19.0						
RNB 80-20	3/4	21.0						
RNB 80-22	7/8	23.0						

■ Conductor section:120~150mm<sup>2</sup>(A.W.G4/0) 1max=300A Material:Copper Thickness:2.5mm

ITEM NO.	American Bolt number	d2 φ (mm)	Dimension(mm)					
			B	L	F	E	D φ	d φ
RNB 100-6	1/4	6.4	28.5	55.6	20.4	21.0	22.1	16.4
RNB 100-8	5/16	8.4						
RNB 100-10	3/8	10.5						
RNB 100-11	7/16	11.5						
RNB 100-12	1/2	13.0						
RNB 100-14	9/16	15.0	32.0	69.0	32.0	21.0	22.1	16.4
RNB 100-16	5/8	17.0						
RNB 100-18	11/16	19.0						
RNB 100-20	3/4	21.0						
RNB 100-22	7/8	23.0						

## 圆形裸端头(TO型)

## RING NON-INSULATED TERMINAL(TYPE TO)

■ Conductor section:150~185mm<sup>2</sup>(A.W.G250/300MCB) 1max=395A Material:Copper Thickness:3.2mm

ITEM NO.	American Bolt number	d2 φ (mm)	Dimension(mm)					
			B	L	F	E	D φ	d φ
RNB 150-8	5/16	8.4	36.0	66.0	23.0	27.0	26.6	19.5
RNB 150-10	3/8	10.5						
RNB 150-11	7/16	11.5						
RNB 150-12	1/2	13.0						
RNB 150-14	9/16	15.0						
RNB 150-16	5/8	17.0	36.0	81.0	36.0	27.0	26.6	19.5
RNB 150-18	11/16	19.0						
RNB 150-20	3/4	21.0						
RNB 150-22	7/8	23.0						
RNB 150-24	15/16	25.0						
RNB 150-27	1	28.0						

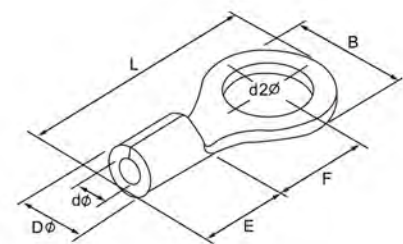

■ Conductor section:185~240mm<sup>2</sup>(A.W.G300/350MCB) 1max=440A Material:Copper Thickness:3.5mm

ITEM NO.	American Bolt number	d2 φ (mm)	Dimension(mm)					
			B	L	F	E	D φ	d φ
RNB 180-8	5/16	8.4	38.5	69.0	24.5	28.5	28.6	21.0
RNB 180-10	3/8	10.5						
RNB 180-11	7/16	11.5						
RNB 180-12	1/2	13.0						
RNB 180-14	9/16	15.0						
RNB 180-16	5/8	17.0	38.5	86.6	39.5	28.5	28.6	21.0
RNB 180-18	11/16	19.0						
RNB 180-20	3/4	21.0						
RNB 180-22	7/8	23.0						
RNB 180-24	15/16	25.0						
RNB 180-27	1	28.0						



■ Conductor section:240~300mm<sup>2</sup>(A.W.G400/500MCB) 1max=470A Material:Copper Thickness:3.9mm

ITEM NO.	American Bolt number	d2 φ (mm)	Dimension(mm)					
			B	L	F	E	D φ	d φ
RNB 200-8	5/16	8.4	44.0	72.0	24.5	31.5	32.6	24.0
RNB 200-10	3/8	10.5						
RNB 200-11	7/16	11.5						
RNB 200-12	1/2	13.0						
RNB 200-14	9/16	15.0						
RNB 200-16	5/8	17.0	44.0	91.0	37.5	31.5	32.6	24.0
RNB 200-18	11/16	19.0						
RNB 200-20	3/4	21.0						
RNB 200-22	7/8	23.0						
RNB 200-24	15/16	25.0						
RNB 200-27	1	28.0						

■ Conductor section:300~400mm<sup>2</sup>(A.W.G500/600MCB) 1max=650A Material:Copper Thickness:4.2mm

ITEM NO.	American Bolt number	d2 φ (mm)	Dimension(mm)					
			B	L	F	E	D φ	d φ
RNB 325-8	5/16	8.4	50.5	88.0	33.5	35.5	37.1	28.0
RNB 325-10	3/8	10.5						
RNB 325-11	7/16	11.5						
RNB 325-12	1/2	13.0						
RNB 325-14	9/16	15.0						
RNB 325-16	5/8	17.0	50.5	105.7	45.0	35.5	37.1	28.0
RNB 325-18	11/16	19.0						
RNB 325-20	3/4	21.0						
RNB 325-22	7/8	23.0						
RNB 325-24	15/16	25.0						
RNB 325-27	1	28.0						

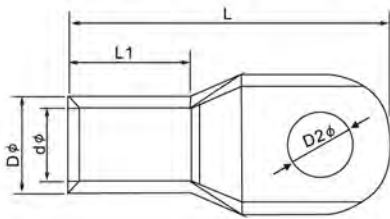

窥口铜接线端头(DTGA型)

**COPPER TUBE TERMINAL(TYPE DTGA)**

ITEM NO.	d2 φ (mm)	Dimension(mm)				Conductor section (mm <sup>2</sup> )
		d φ	D φ	L1	L	
SC 1.5-5	5.3	1.9	3.35	6.5	18.0	1.5
SC 2.5-4	4.3	2.6	4.0	7.0	18.0	2.5
SC 2.5-5	5.3	2.6	4.0	7.0	20.0	2.5
SC 4-5	5.3	3.2	4.8	7.5	20.5	4
SC 4-6	6.4	3.2	4.8	7.5	22.0	4
SC 6-5	5.3	4.1	5.5	9.0	23.0	6
SC 6-6	6.4	4.1	5.5	9.0	23.0	6
SC 10-6	6.4	5.1	6.5	9.5	25.0	10
SC 10-8	8.4	5.1	6.5	9.5	27.0	10
SC 16-6	6.4	6.4	8.0	12.2	30.7	16
SC 16-8	8.4	6.4	8.0	12.2	30.7	16
SC 25-6	6.4	7.4	9.0	13.3	34.0	25
SC 25-8	8.4	7.4	9.0	13.3	34.0	25
SC 35-8	8.4	8.5	10.5	14.5	38.0	35
SC 35-10	10.5	8.5	10.5	14.5	38.0	35
SC 50-8	8.4	9.6	12.0	16.5	42.5	50
SC 50-10	10.5	9.6	12.0	16.5	42.5	50
SC 70-10	10.5	11.9	14.5	19.0	50.0	70
SC 70-12	13.0	11.9	14.5	19.0	50.0	70
SC 95-10	10.5	13.2	16.0	20.3	56.5	95
SC 95-12	13.0	13.2	16.0	20.3	56.5	95
SC 120-12	13.0	15.6	19.0	24.5	64.0	120
SC 120-16	17.0	15.6	19.0	24.5	64.0	120
SC 150-12	13.0	17.4	21.0	29.0	69.0	150
SC 150-16	17.0	17.4	21.0	29.0	69.0	150
SC 185-12	13.0	19.0	23.0	32.0	72.0	185
SC 185-16	17.0	19.0	23.0	32.0	72.0	185
SC 240-16	17.0	21.8	26.0	38.0	92.0	240
SC 240-20	21.0	21.8	26.0	38.0	92.0	240
SC 300-16	17.0	24.8	30.0	43.0	101.0	300
SC 300-20	21.0	24.8	30.0	43.0	101.0	300
SC 400-16	17.0	28.0	34.0	46.0	110.0	400
SC 400-20	21.0	28.0	34.0	46.0	110.0	400
SC 500-16	17.0	30.0	38.0	47.0	119.0	500
SC 500-20	21.0	30.0	38.0	47.0	119.0	500
SC 630-20	21.0	35.0	45.0	56.0	135.0	630
SC 800-BL	-	39.0	50.0	60.0	170.0	800
SC 1000-BL	-	44.0	56.0	87.0	200.0	1000



## 管形预绝缘端头(TG-JT型)

## INSULATED CORD END TERMINAL(TYPE TG-JT)

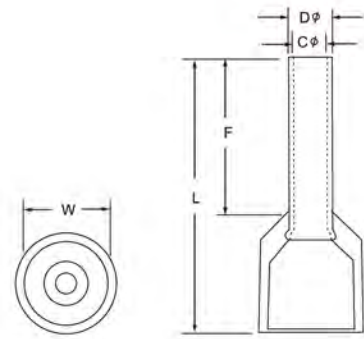
■ U<sub>max</sub>:105℃ U<sub>i</sub>=300V Material:CopperPipe Insulating Material:Nylon(多种颜色)

ITEM NO.	Dimension(mm)						mm <sup>2</sup>	Color of insulation sheath (Top)Germany (Bottom)France
	F	L	W	Dφ	Cφ	A.W.G		
E 0506	6.0	12.0	3.4	1.3	1.0	#22	0.5	Orange White
E 0508	8.0	14.0						
E 0510	10.0	16.0						
E 0512	12.0	18.0						
E 7506	6.0	12.4	3.4	1.5	1.2	#20	0.75	White Blue
E 7508	8.0	14.4						
E 7510	10.0	16.4						
E 7512	12.0	18.4						
E 1006	6.0	12.5	3.6	1.7	1.4	#18	1.0	Yellow Red
E 1008	8.0	14.5						
E 1010	10.0	16.5						
E 1012	12.0	18.5						
E 1508	8.0	15.4	4.0	2.0	1.7	#16	1.5	Red Black
E 1510	10.0	17.4						
E 1512	12.0	19.4						
E 1518	18.0	25.4						
E 2508	8.0	15.0	4.6	2.6	2.3	#14	2.5	Blue Gray
E 2510	10.0	17.0						
E 2512	12.0	19.0						
E 2518	18.0	25.0						
E 4009	9.0	17.0	5.5	3.2	2.8	#12	4.0	Gray Orange
E 4012	12.0	21.0						
E 4018	18.0	27.0						
E 6010	10.0	19.0	6.7	3.9	3.5	#10	6.0	Black Green
E 6012	12.0	21.0						
E 6018	18.0	26.0						
E 10-12	12.0	20.8	8.3	4.9	4.5	#7	10.0	Ivory Brown
E 10-18	18.0	26.8						
E 16-12	12.0	22.2	9.4	6.2	5.8	#5	16.0	Green Ivory
E 16-18	18.0	27.6						
E 25-16	16.0	27.6	11.7	7.9	7.5	#4	25.0	Brown Black
E 25-22	22.0	33.5						
E 35-16	16.0	30.0	13.0	8.7	8.3	#2	35.0	Dust-colour
E 35-25	25.0	39.0						
E 50-20	20.0	35.5	15.8	10.9	10.3	#1	50.0	Olives color
E 50-25	25.0	40.5						



**管形裸端头(TG型)**

**NON-INSULATED CORD END TERMINAL(TYPE TG)**

■ Umax:1 Ui=300V Material:CopperPipe

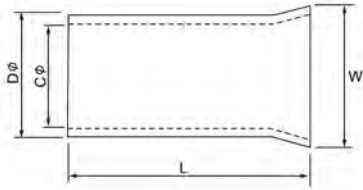

ITEM NO.	Dimension(mm)				Conductor section mm <sup>2</sup>	
	L	D φ	C φ	W	A.W.G	mm <sup>2</sup>
EN 0506	6.0	1.3	1.0	1.7	#22	0.5
EN 0508	8.0					
EN 0510	10.0					
EN 0512	12.0					
EN 7506	6.0	1.5	1.2	1.9	#20	0.75
EN 7508	8.0					
EN 7510	10.0					
EN 7512	12.0					
EN 1006	6.0	1.8	1.4	2.2	#18	1.0
EN 1008	8.0					
EN 1010	10.0					
EN 1012	12.0					
EN 1507	7.0	2.0	1.7	2.5	#16	1.5
EN 1508	8.0					
EN 1510	10.0					
EN 1512	12.0					
EN 1518	18.0					
EN 2507	7.0	2.6	2.2	3.3	#14	2.5
EN 2508	8.0					
EN 2510	10.0					
EN 2512	12.0					
EN 2518	18.0					
EN 4009	9.0	3.2	2.8	3.9	#12	4.0
EN 4012	12.0					
EN 4018	18.0					
EN 6010	10.0	3.9	3.5	4.8	#10	6.0
EN 6012	12.0					
EN 6015	15.0					
EN 6018	18.0					
EN 10-12	12.0	4.9	4.5	5.8	#7	10.0
EN 10-15	15.0					
EN 10-18	18.0					
EN 16-12	12.0	6.2	5.8	7.2	#5	16.0
EN16-15	15.0					
EN 16-18	18.0					
EN 25-16	16.0	7.9	7.5	9.1	#4	25.0
EN 25-22	22.0					
EN 35-16	16.0	8.7	8.3	10.2	#2	35.0
EN 35-25	25.0					
EN 50-20	20.0	10.9	10.3	12.4	#1	50.0
EN 50-25	25.0					

## 双线管形预绝缘端头

## INSULATED TWIN CORD END TERMINAL

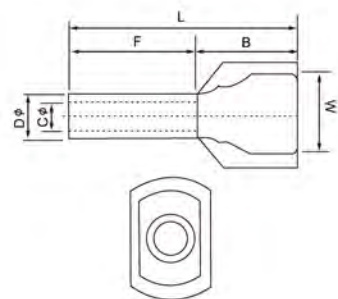
■ U<sub>max</sub>:105℃ U<sub>i</sub>=300V Material:CopperPipe Insulating Cover Material:Nylon

ITEM NO.	Conductor (mm <sup>2</sup> )	Dimension(mm)						Color	
		F	L	W	B	D φ	C φ	German	French
TE 0508	2 × 0.5	8.0	14.0	5.0	6.0	1.8	1.5	White	White
TE 7508	2 × 0.75	8.0	14.5	5.5	6.5	2.1	1.8	Blue	Gray
TE 7510	2 × 0.75	10.0	16.5	5.5	6.5	2.1	1.8		
TE 1008	2 × 1.0	8.0	14.9	5.5	6.9	2.3	2.0	Red	Red
TE 1010	2 × 1.0	10.0	16.9	5.5	6.9	2.3	2.0		
TE 1508	2 × 1.5	8.0	16.7	6.7	8.7	2.6	2.3	Black	Blue
TE 1512	2 × 1.5	12.0	20.7	6.7	8.7	2.6	2.3		
TE 2510	2 × 2.5	10.0	19.8	8.0	9.8	3.3	2.9	Gray	Blue
TE 2513	2 × 2.5	13.0	22.8	8.0	9.8	3.3	2.9		
TE 4012	2 × 4.0	12.0	21.2	8.8	9.2	4.2	3.8	Orange	Gray
TE 6014	2 × 6.0	14.0	23.5	9.5	9.5	5.3	4.9	Green	Yellow
TE 10-14	2 × 10.0	14.0	26.5	12.6	12.5	6.9	6.5	Brown	Red
TE 16-14	2 × 16.0	14.0	30.0	19.0	16.0	8.7	8.3	Ivory	Blue

## 快速连接接头

## SPLICE CONNECTOR

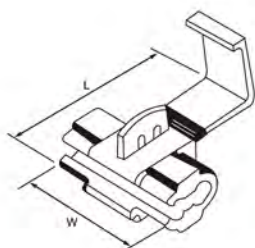
■ 1max:22-18 A.W.G:10 18-14 A.W.G:15A 12-10A.W.G:24A  
U<sub>max</sub>:105℃ 600V Material:brass Insulating Material:PP

ITEM NO.	Dimension(mm)		A.W.G mm <sup>2</sup>	Color
	W	L		
878100	20.0	27.0	22-18A.W.G 0.5-1.0mm <sup>2</sup>	Red
878101	20.0	27.0	18-14A.W.G 0.75-2.5mm <sup>2</sup>	Blue
878101	20.0	27.0	18-14A.W.G 0.75-2.5mm <sup>2</sup>	White
878100	20.5	34.5	12-10A.W.G 4-6mm <sup>2</sup>	Yellow

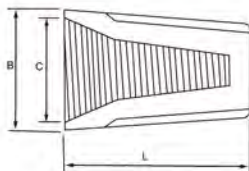
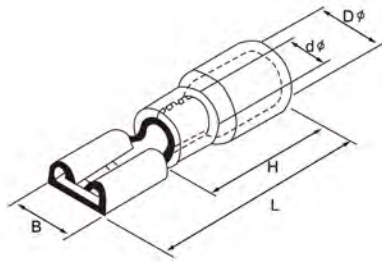

**母预绝缘端头**

**VINYL-INSULATED FEMALE DISCONNECTORS**

■ Conductor section:0.5~1.5mm<sup>2</sup>(A.W.G22~16) 1max=10A Material:Brass

ITEM NO.	Nema Tab (mm)	Thickness of material	Dimension(mm)					Color
			B	Dφ	dφ	L	H	
FDD 1.25-110(5)	0.5 × 2.8	0.3	3.8	3.8	1.7	18.7	10.6	Red
FDD 1.25-110(8)	0.8 × 2.8	0.3	3.8	3.8	1.7	18.7	10.6	
FDD 1.25-187(5)	0.5 × 4.75	0.35	5.6	3.8	1.7	18.7	10.6	
FDD 1.25-187(8)	0.8 × 4.75	0.35	5.6	3.8	1.7	18.7	10.6	
FDD 1.25-205	0.5 × 5.2	0.35	6.5	3.8	1.7	20.0	10.6	
FDD 1.25-250	0.8 × 6.35	0.4	7.4	3.8	1.7	21.0	10.6	

■ Conductor section:1.5~2.5mm<sup>2</sup>(A.W.G16~14) 1max=15A Material:Brass

ITEM NO.	Nema Tab (mm)	Thickness of material	Dimension(mm)					Color
			B	Dφ	dφ	L	H	
FDD 2-110(5)	0.5 × 2.8	0.3	3.8	4.3	2.3	18.7	10.6	Blue
FDD 2-110(8)	0.8 × 2.8	0.3	3.8	4.3	2.3	18.7	10.6	
FDD 2-187(5)	0.5 × 4.75	0.35	5.6	4.3	2.3	18.7	10.6	
FDD 2-187(8)	0.8 × 4.75	0.35	5.6	4.3	2.3	18.7	10.6	
FDD 2-205	0.5 × 5.2	0.35	6.5	4.3	2.3	19.7	10.6	
FDD 2-250	0.8 × 6.35	0.4	7.4	4.3	2.3	21.4	10.6	
FDD 2-312	0.8 × 8.0	0.4	8.9	4.3	2.3	24.1	10.6	

■ Conductor section:4~6mm<sup>2</sup>(A.W.G12~10) 1max=24A Material:Brass

ITEM NO.	Nema Tab (mm)	Thickness of material	Dimension(mm)					Color
			B	Dφ	dφ	L	H	
FDD 5.5-250	0.8 × 6.35	0.4	7.4	5.7	3.4	24.5	13.0	Yellow
FDD 5.5-375	1.2 × 9.4	0.5	10.9	5.7	3.4	29.3	13.5	

**螺旋式压线帽**

**SCREW ON WIRE CONNECTOR**

ITEM NO.	Lead combination range	Dimension(mm)			Color
		L	B	C	
SP1	Min0.75 × 1+0.5 × 1 Max1.5 × 2	8.5	3.5	14.7	Gray
SP2	Min0.75 × 3 Max1.5 × 3	10.1	6.5	17.5	Blue
SP3	Min0.75 × 3 Max1.5 × 3+1 × 1	11.2	8.0	21.4	Orange
SP4	Min0.25 × 1+0.75 × 1 Max2.5 × 4+0.75 × 1	13.7	7.5	23.6	Yellow
SP6	Min0.25 × 2 Max6 × 3+4 × 2	16.0	7.0	26.5	Red

## 公预绝缘端头

## VINYL-INSULATED MALE DISCONNECTORS

■ Conductor section:0.5~1.5mm<sup>2</sup>(A.W.G22~16) 1max=10A Material:Brass

ITEM NO.	Nema Tab (mm)	Thickness of material	Dimension(mm)					Color
			B	D $\phi$	d $\phi$	L	H	
MDD 1.25-110(5)	0.5 × 2.8	0.5	2.8	4.3	1.7	17.7	10.6	Red
MDD 1.25-110(8)	0.8 × 2.8	0.8	2.8	4.3	1.7	17.7	10.6	
MDD 1.25-187(5)	0.5 × 4.75	0.5	4.75	4.3	1.7	20.0	10.6	
MDD 1.25-187(8)	0.8 × 4.75	0.8	4.75	4.3	1.7	20.0	10.6	
MDD 1.25-250	0.8 × 6.35	0.4 × 2	6.35	4.3	1.7	21.6	10.6	

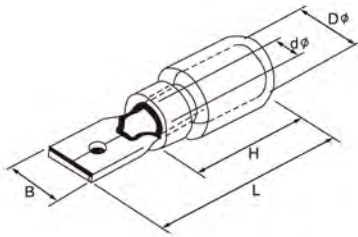
■ Conductor section:1.5~2.5mm<sup>2</sup>(A.W.G16~14) 1max=15A Material:Brass

ITEM NO.	Nema Tab (mm)	Thickness of material	Dimension(mm)					Color
			B	D $\phi$	d $\phi$	L	H	
MDD 2-187(5)	0.5 × 4.75	0.5	4.75	4.3	2.3	20.0	10.6	Blue
MDD 2-187(8)	0.8 × 4.75	0.8	4.75	4.3	2.3	20.0	10.6	
MDD 2-250	0.8 × 6.35	0.4 × 2	6.35	4.3	2.3	21.6	10.6	

■ Conductor section:4~6mm<sup>2</sup>(A.W.G12~10) 1max=24A Material:Brass

ITEM NO.	Nema Tab (mm)	Thickness of material	Dimension(mm)					Color
			B	D $\phi$	d $\phi$	L	H	
MDD 5.5-250	0.8 × 6.35	0.4 × 2	6.35	5.7	3.4	25.5	13.5	Yellow

## CLOSE-END WIRE CONNECTOR

■ Shell material:Nylon 66,94V-2,certificated agree by UL.

Usage:Peel the coat of wire,then insert to tube,use pincers to fix them.

Feature:Nylon shell,long copper tube,easy to conduct electricity and hold wire tightly.

ITEM NO.	Nema Tab (mm)	W(mm)		D (mm)	Suitable Wires		Packing
		B	C		mm <sup>2</sup>	AWG	
DL- $\Phi$ 3	17.8	7.2	3.6	2.5	1.25	22-16	100PCS& 1000PCS
DL- $\Phi$ 4	21.0	8.2	4.0	2.9	2.0	16-14	
DL- $\Phi$ 5	22.5	9.0	4.8	3.9	5.5	12-10	
DL- $\Phi$ 6	25.0	10.0	5.6	4.5	8.0	8	100PCS& 500PCS
DL- $\Phi$ 7	24.2	11.0	6.5	5.4	10	8-6	
DL- $\Phi$ 8	25.6	11.8	7.5	6.0	13	6	
DL- $\Phi$ 10	29.5	13.5	9.3	7.5	16	4	100PCS

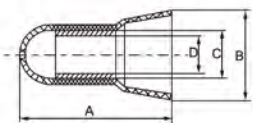

**母全绝缘端头**

**VINYL FULLY INSULATED FEMALE DISCONNECTORS**

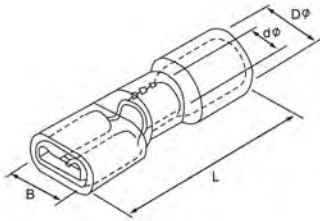

■ Conductor section: 0.5~1.5mm<sup>2</sup>(A.W.G22~16) 1max=10A Material: Brass

ITEM NO.	Nema Tab (mm)	Dimension(mm)			
		B	D φ	d φ	L
FDFD 1.25-187(5)	0.5 × 4.75	5.6	3.8	1.7	20.8
FDFD 1.25-187(8)	0.8 × 4.75	5.6	3.8	1.7	20.8
FDFD 1.25-250	0.8 × 6.35	7.4	3.8	1.7	24.3

■ Conductor section: 1.5~2.5mm<sup>2</sup>(A.W.G16~14) 1max=15A Material: Brass

ITEM NO.	Nema Tab (mm)	Dimension(mm)			
		B	D φ	d φ	L
FDFD 2-187(5)	0.5 × 4.75	5.6	4.3	2.3	20.8
FDFD 2-187(8)	0.8 × 4.75	5.6	4.3	2.3	20.8
FDFD 2-250	0.8 × 6.35	7.4	4.3	2.3	24.3

■ Conductor section: 4~6mm<sup>2</sup>(A.W.G12~10) 1max=24A Material: Brass

ITEM NO.	Nema Tab (mm)	Dimension(mm)			
		B	D φ	d φ	L
FDFD 5.5-250	0.8 × 6.35	7.4	5.7	3.4	24.3



**肩背形公母预绝缘端头**

**VINYL-INSULATED PIGGY-BACK DISCONNECTORS**

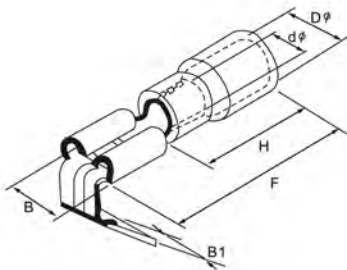

■ Conductor section: 0.5~1.5mm<sup>2</sup>(A.W.G22~16) 1max=10A Material: Brass

ITEM NO.	Nema Tab (mm)	Dimension(mm)					
		B	B1	H	D φ	d φ	L
PBDD 1.25-250	0.8 × 6.35	7.4	6.3	10.6	3.8	1.7	21.0

■ Conductor section: 1.5~2.5mm<sup>2</sup>(A.W.G16~14) 1max=15A Material: Brass

ITEM NO.	Nema Tab (mm)	Dimension(mm)					
		B	B1	H	D φ	d φ	L
PBDD 2-250	0.8 × 6.35	7.7	6.3	10.6	4.3	2.3	21.0

■ Conductor section: 4~6mm<sup>2</sup>(A.W.G12~10) 1max=24A Material: Brass

ITEM NO.	Nema Tab (mm)	Dimension(mm)					
		B	B1	H	D φ	d φ	L
PBDD 5.5-250	0.8 × 6.35	7.7	6.3	13.5	5.7	3.4	23.5



## 片形预绝缘端头

## VINYL-INSULATED BLADE TERMINAL

■ Conductor section: 0.5~1.5mm<sup>2</sup> (A.W.G22~16) 1max=19A Material: Copper Thickness: 0.75mm

ITEM NO.	Dimension(mm)					Color
	B	L	F	H	Dφ	
DBV 1.25-10	2.3	20.6	10.0	10.6	4.3	Red
DBV 1.25-11	2.3	21.6	11.0			
DBV 1.25-14	2.3	24.6	14.0			
DBV 1.25-18	2.3	28.6	18.0			

■ Conductor section: 1.5~2.5mm<sup>2</sup> (A.W.G16~14) 1max=27A Material: Copper Thickness: 0.8mm

ITEM NO.	Dimension(mm)					Color
	B	L	F	H	Dφ	
DBV 2-10	2.55	20.5	9.9	10.6	4.9	Blue
DBV 2-14	2.55	24.6	14.0			
DBV 2-18	2.55	28.6	18.0			

■ Conductor section: 4~6mm<sup>2</sup> (A.W.G12~10) 1max=48A Material: Copper Thickness: 1.0mm

ITEM NO.	Dimension(mm)					Color
	B	L	F	H	Dφ	
DBV 5.5-10	2.8	23.3	9.8	13.5	5.6	Yellow
DBV 5.5-14	4.5	27.3	13.8			
DBV 5.5-18	4.5	31.3	17.8			

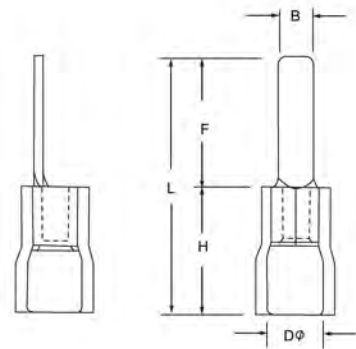

## 片形裸端头

## NON-INSULATED BLADE TERMINAL

■ Conductor section: 0.5~1.5mm<sup>2</sup> (A.W.G22~16) 1max=19A Material: Copper Thickness: 0.75mm

ITEM NO.	Dimension(mm)					
	B	L	F	E	Dφ	dφ
DBN 1.25-10	2.4	14.8	10.0	4.8	3.4	1.7
DBN 1.25-11	2.4	15.8	11.0			
DBN 1.25-14	2.4	18.8	14.0			
DBN 1.25-18	2.4	22.8	18.0			

■ Conductor section: 1.5~2.5mm<sup>2</sup> (A.W.G16~14) 1max=27A Material: Copper Thickness: 0.8mm

ITEM NO.	Dimension(mm)					
	B	L	F	E	Dφ	dφ
DBN 2-9	2.5	14.6	9.9	4.8	4.1	2.3
DBN 2-18	2.5	22.8	18.0			

■ Conductor section: 4~6mm<sup>2</sup> (A.W.G12~10) 1max=48A Material: Copper Thickness: 1.0mm

ITEM NO.	Dimension(mm)					
	B	L	F	E	Dφ	dφ
DBN 5.5-10	2.8	14.8	10.0	6.0	5.6	3.4
DBN 5.5-14	4.5	21.0	14.0			
DBN 5.5-18	4.5	23.0	18.0			
DBN 8-14	5.0	22.5	14.0	8.5	7.2	4.5
DBN 14-16	6.0	30.6	16.0	14.0	9.0	6.5

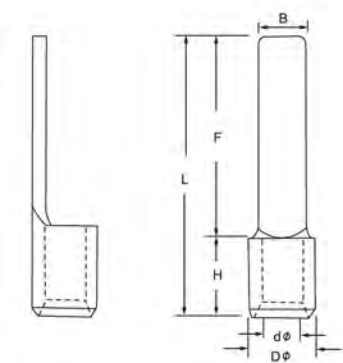

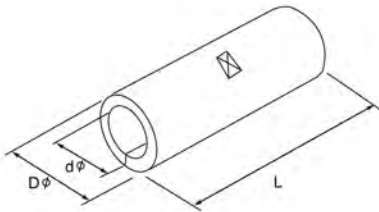
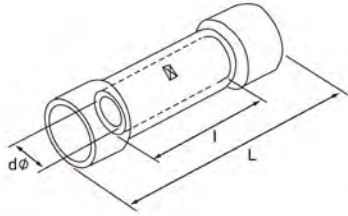

**长形全绝缘中间接头(TL-JTK型)**

**VINYL-INSULATED BUTT SPLICE TERMINAL(TYPE TL-JTK)**

■ Material:Copper Insulating Material:PVC

ITEM NO.	Conductor section		Dimension(mm)			Imax	Color
	A.W.G	mm <sup>2</sup>	l	d φ	L		
BV 1.25	22-16	0.5-1.5	15.0	1.7	25.0	19A	Red
BV 2	16-14	1.5-2.5	15.0	2.3	25.0	27A	Blue
BV 5.5	12-10	4-6	15.0	3.4	25.0	48A	Yellow
BV 8	#8	6-10	21.0	4.5	32.0	62A	Red
BV 14	#6	10-16	26.0	5.8	42.0	88A	Blue
BV 22	#4	16-25	29.0	7.7	50.0	115A	Yellow
BV 38	#2	35-50	32.0	9.4	55.0	160A	Red

**短形全绝缘中间接头(TL-JTK型)**

**VINYL-INSULATED PARALLEL TERMINAL(TYPE TL-JTK)**

■ Material:Copper Insulating Material:PVC

ITEM NO.	Conductor section		Dimension(mm)			Imax	Color
	A.W.G	mm <sup>2</sup>	l	d φ	L		
PVT 1.25	22-16	0.5-1.5	8.0	1.7	16.0	19A	Red
PVT 2	16-14	1.5-2.5	8.0	2.3	16.0	27A	Blue
PVT 5.5	12-10	4-6	8.0	3.4	20.5	48A	Yellow

**中间裸接头(TL型)**

**NON-INSULATED BUTT SPLICE TERMINAL**

■ Material:Copper

ITEM NO.	Conductor section		Dimension(mm)		
	A.W.G	mm <sup>2</sup>	D φ	d φ	L
BN 1.25	22-16	0.5-1.5	3.3	1.7	15.0
BN 2	16-14	1.5-2.5	4.0	2.3	15.0
BN 3.5	14-12	2.5-4	5.0	3.0	15.0
BN 5.5	12-10	4-6	5.5	3.4	15.0
BN 8	#8	10	7.1	4.5	21.0
BN 14	#6	16	9.0	5.8	26.0
BN 22	#4	25	11.4	7.7	29.0
BN 38	#2	35	13.3	9.4	32.0
BN 60	1/0	50	15.4	11.4	36.0
BN 70	2/0	70	17.5	13.3	37.0
BN 80	3/0	95	19.4	14.5	38.0
BN 100	4/0	120	22.0	16.4	38.0
BN 150	250-300MCM	150	26.5	19.5	54.0
BN 180	300-350MCM	185	28.5	21.0	57.0
BN 200	400MCM	240	32.5	24.0	63.0
BN 325	500-600MCM	300	37.0	28.0	72.0



## 子弹形公预绝缘接头

## VINYL-INSULATED BULLET DISCONNECTORS

■ Conductor section: 0.5~1.5mm<sup>2</sup>(A.W.G22~16) 1max=10A Material: Brass

ITEM NO.	Thickness of material	Dimension(mm)					Color
		b φ	F	D φ	H	L	
MPD 1.25-156	0.4	4.0	10.6	1.7	10.6	21.2	Red

■ Conductor section: 1.5~2.5mm<sup>2</sup>(A.W.G16~14) 1max=15A Material: Brass

ITEM NO.	Thickness of material	Dimension(mm)					Color
		b φ	F	D φ	H	L	
MPD 2-156	0.4	4.0	10.6	2.3	12.6	21.2	Blue
MPD 2-196	0.4	5.0	10.6	2.3	10.0	21.2	

■ Conductor section: 4~6mm<sup>2</sup>(A.W.G12~10) 1max=24A Material: Brass

ITEM NO.	Thickness of material	Dimension(mm)					Color
		b φ	F	D φ	H	L	
MPD 5.5-195	0.4	5.0	12.0	3.4	13.5	25.5	Yellow

## 子弹形母预绝缘接头

## VINYL FULLY INSULATED RECEPTACLE DISCONNECTORS

■ Conductor section: 0.5~1.5mm<sup>2</sup>(A.W.G22~16) 1max=10A Material: Brass

ITEM NO.	Thickness of material	Dimension(mm)					Color
		b φ	B φ	D φ	F	L	
FRD 1.25-156	0.4	4.0	6.3	1.7	13.0	24.5	Red

■ Conductor section: 1.5~2.5mm<sup>2</sup>(A.W.G16~14) 1max=15A Material: Brass

ITEM NO.	Thickness of material	Dimension(mm)					Color
		b φ	B φ	D φ	F	L	
FRD 2-156	0.4	4.0	6.3	2.3	14.0	24.5	Blue
FRD 2-195	0.4	5.0	7.0	2.3	14.0	25.5	

■ Conductor section: 4~6mm<sup>2</sup>(A.W.G12~10) 1max=24A Material: Brass

ITEM NO.	Thickness of material	Dimension(mm)					Color
		b φ	F	D φ	F	L	
FRD 5.5-195	0.4	5.0	7.0	3.4	14.0	24.5	Yellow

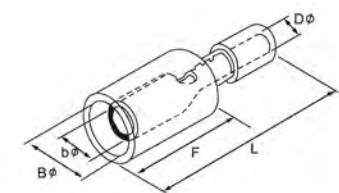
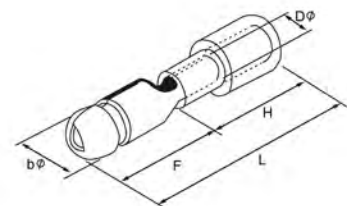

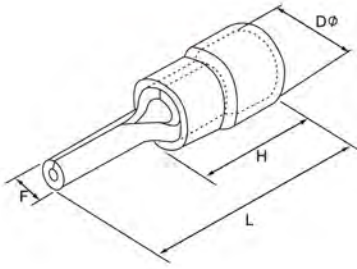

**针形预绝缘端头(TZ-JTK型)**

**VINYL-INSULATED PIN TERMINAL(TYPE TZ-JTK)**

■ Conductor section:0.5~1.5mm<sup>2</sup>(A.W.G22~16) 1max=19A Material:Copper Thickness:0.75mm

ITEM NO.	Dimension(mm)				Color
	F	L	H	D φ	
PTV 1.25-9	1.9	19.0	10.6	4.3	Red
PTV 1.25-10	1.9	20.6			
PTV 1.25-12	1.9	22.6			
PTV 1.25-13	1.9	23.6			
PTV 1.25-18	1.9	28.6			

■ Conductor section:1.5~2.5mm<sup>2</sup>(A.W.G16~14) 1max=27A Material:Copper Thickness:0.8mm

ITEM NO.	Dimension(mm)				Color
	F	L	H	D φ	
PTV 2-9	1.9	19.0	10.6	4.9	Blue
PTV 2-10	1.9	20.6			
PTV 2-12	1.9	22.0			
PTV 2-13	1.9	23.6			
PTV 2-18	1.9	28.6			

■ Conductor section:2.5~4mm<sup>2</sup>(A.W.G14~12) 1max=36A Material:Copper Thickness:1.0mm

ITEM NO.	Dimension(mm)				Color
	F	L	H	D φ	
PTV 3.5-10	2.8	20.0	13.0	6.2	Black
PTV 3.5-12	2.8	25.5			

■ Conductor section:4~6mm<sup>2</sup>(A.W.G12~10) 1max=48A Material:Copper Thickness:1.0mm

ITEM NO.	Dimension(mm)				Color
	F	L	H	D φ	
PTV 5.5-13	2.8	26.0	13.5	6.7	Yellow

**针形裸端头(TZ型)**

**NON-INSULATED PIN TERMINAL(TYPE TZ)**

■ Conductor section:0.5~1.5mm<sup>2</sup>(A.W.G22~16) 1max=19A Material:Copper Thickness:0.75mm

ITEM NO.	Dimension(mm)				Color
	F	L	E	D φ	
PTN 1.25-9	1.9	13.8	4.8	3.4	1.7
PTN 1.25-10	1.9	14.8			
PTN 1.25-12	1.9	16.8			
PTN 1.25-13	1.9	17.8			
PTN 1.25-18	1.9	22.8			

■ Conductor section:1.5~2.5mm<sup>2</sup>(A.W.G16~14) 1max=27A Material:Copper Thickness:0.8mm

ITEM NO.	Dimension(mm)				Color
	F	L	E	D φ	
PTN 2-9	1.9	13.8	4.8	4.1	2.3
PTN 2-10	1.9	14.8			
PTN 2-12	1.9	16.8			
PTN 2-13	1.9	17.8			
PTN 2-18	1.9	22.8			

■ Conductor section:2.5~4mm<sup>2</sup>(A.W.G14~12) 1max=37A Material:Copper Thickness:1.0mm

ITEM NO.	Dimension(mm)				Color
	F	L	E	D φ	
PTN 3.5-10	2.8	14.8	6.0	5.0	3.0
PTN 3.5-13	2.8	19.8			

■ Conductor section:4~6mm<sup>2</sup>(A.W.G12~10) 1max=48A Material:Copper Thickness:1.0mm

ITEM NO.	Dimension(mm)				Color
	F	L	H	D φ	
PTN 5.5-13	2.8	19.8	6.0	5.6	3.4

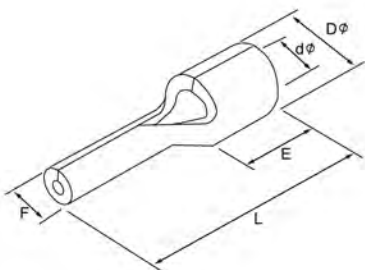

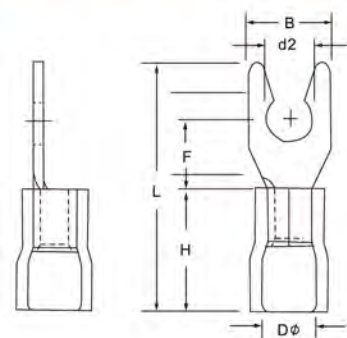

## 锁扣叉形预绝缘端头

## LOCKING SPADE VINYL-INSULATED TERMINAL

■ Conductor section: 0.5~1.5mm<sup>2</sup> (A.W.G22~16) 1max=19A Material: Copper Thickness: 0.75mm

ITEM NO.	American Bolt number	d2 φ (mm)	Dimension(mm)					Color
			B	L	F	H	D φ	
LSV 1.25-3.5	#6	3.7	6.4	21.2	6.5	10.0	4.3	Red
LSVS 1.25-4	#8	4.3	7.2	21.2	6.5			
LSVL 1.25-4	#8	4.3	8.1	21.2	6.5			
LSVS 1.25-5	#10	5.3	8.1	21.2	6.5			
LSVL 1.25-5	#10	5.3	9.5	21.2	6.5			



■ Conductor section: 1.5~2.5mm<sup>2</sup> (A.W.G16~14) 1max=27A Material: Copper Thickness: 0.8mm

ITEM NO.	American Bolt number	d2 φ (mm)	Dimension(mm)					Color
			B	L	F	H	D φ	
LSV 2-3.5	#6	3.7	6.0	21.2	6.5	10.0	4.9	Blue
LSVS 2-4	#8	4.3	7.2	21.2	6.5			
LSVL 2-4	#8	4.3	8.1	21.2	6.5			
LSVS 2-5	#10	5.3	8.1	21.2	6.5			
LSVL 2-5	#10	5.3	9.5	21.2	6.5			

■ Conductor section: 4~6mm<sup>2</sup> (A.W.G12~10) 1max=48A Material: Copper Thickness: 1.0mm

ITEM NO.	American Bolt number	d2 φ (mm)	Dimension(mm)					Color
			B	L	F	H	D φ	
LSV 5.5-3.5	#6	3.7	8.3	25.2	7.5	13.0	6.7	Yellow
LSV 5.5-4	#8	4.3	8.3	25.2	7.5			
LSV 5.5-4	#10	5.3	9.0	23.9	7.5			
LSV 5.5-5	1/4	6.4	12.0	31.2	12.0			

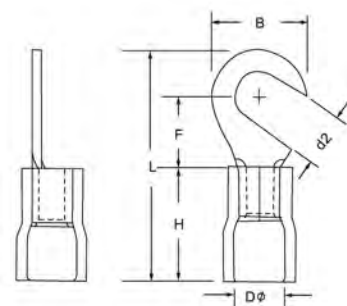

## 钩形预绝缘端头

## HOOK RING VINYL-INSULATED TERMINAL

■ Conductor section: 0.5~1.5mm<sup>2</sup> (A.W.G22~16) 1max=19A Material: Copper Thickness: 0.75mm

ITEM NO.	American Bolt number	d2 φ (mm)	Dimension(mm)					Color
			B	L	F	H	D φ	
HV 1.25-3.5	#6	3.7	8.0	21.0	7.0	10.0	4.3	Red
HV 1.25-4	#8	4.3	8.0	21.0	7.0			
HV 1.25-5	#10	5.3	8.0	21.0	7.0			
HV 1.25-6	1/4	6.4	11.6	27.0	11.1			

■ Conductor section: 1.5~2.5mm<sup>2</sup> (A.W.G16~14) 1max=27A Material: Copper Thickness: 0.8mm

ITEM NO.	American Bolt number	d2 φ (mm)	Dimension(mm)					Color
			B	L	F	H	D φ	
HV 2-3.5	#6	3.7	8.5	22.0	7.75	10.0	4.9	Blue
HV 2-4	#8	4.3	8.5	22.0	7.75			
HV 2-5	#10	5.3	9.5	22.0	7.25			
HV 2-6	1/4	6.4	12.0	27.0	11.0			



■ Conductor section: 4~6mm<sup>2</sup> (A.W.G12~10) 1max=48A Material: Copper Thickness: 1.0mm

ITEM NO.	American Bolt number	d2 φ (mm)	Dimension(mm)					Color
			B	L	F	H	D φ	
HV 5.5-3.5	#6	3.7	7.2	21.4	5.9	13.0	6.7	Yellow
HV 5.5-4	#8	4.3	9.5	25.5	8.25			
HV 5.5-5	#10	5.3	9.5	25.5	8.25			
HV 5.5-6	1/4	6.4	12.0	31.5	13.0			

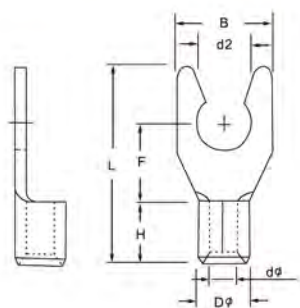

## 锁扣叉形裸端头

## LOCKING SPADE NON-INSULATED TERMINAL

■ 1max=19A Material:Copper Thickness:0.75mm

ITEM NO.	d2 φ (mm)	Dimension(mm)						A.W.G mm <sup>2</sup>
		B	F	L	E	D φ	d φ	
LSNB 1.25-3.5	3.7	6.4	6.5	16.0	4.8	3.4	1.7	22-16A.W.G 0.5-1.5mm <sup>2</sup>
LSNBS 1.25-4	4.3	7.2						
LSNBL 1.25-4	4.3	8.1						
LSNBS 1.25-5	5.3	8.1						
LSNBL 1.25-5	5.3	9.5						

■ 1max=27A Material:Copper Thickness:0.8mm

ITEM NO.	d2 φ (mm)	Dimension(mm)						A.W.G mm <sup>2</sup>
		B	F	L	E	D φ	d φ	
LSNB 2-3.5	3.7	6.0	6.5	16.0	4.8	4.1	2.3	16-14A.W.G 1.5-2.5mm <sup>2</sup>
LSNBS 2-4	4.3	7.2						
LSNBL 2-4	4.3	8.1						
LSNBS 2-5	5.3	8.1						
LSNBL 2-5	5.3	9.5						

■ 1max=48A Material:Copper Thickness:1.0mm

ITEM NO.	d2 φ (mm)	Dimension(mm)						A.W.G mm <sup>2</sup>
		B	F	L	E	D φ	d φ	
LSNB 5.5-3.5	3.7	8.3	7.5	19.5	6.0	5.6	3.4	12-10A.W.G 4-6mm <sup>2</sup>
LSNB 5.5-4	4.3	8.3						
LSNB 5.5-5	5.3	9.0						
LSNB 5.5-6	6.4	12.0	12.0	24.5				



## 钩形裸端头

## HOOK RING NON-INSULATED TERMINAL

■ 1max=19A Material:Copper Thickness:0.75mm

ITEM NO.	d2 φ (mm)	Dimension(mm)						A.W.G mm <sup>2</sup>
		B	F	L	E	D φ	d φ	
HNB 1.25-3.5	3.7	8.0	7.0	15.8	4.8	3.4	1.7	22-16A.W.G 0.5-1.5mm <sup>2</sup>
HNB 1.25-4	4.3							
HNB 1.25-5	5.3							
HNB 1.25-6	6.4	11.6	11.0	21.8				

■ 1max=27A Material:Copper Thickness:0.8mm

ITEM NO.	d2 φ (mm)	Dimension(mm)						A.W.G mm <sup>2</sup>
		B	F	L	E	D φ	d φ	
HNB 2-3.5	3.7	8.5	7.8	16.8	4.8	4.1	2.3	16-14A.W.G 1.5-2.5mm <sup>2</sup>
HNB 2-4	4.3							
HNB 2-5	5.3							
HNB 2-6	6.4							

■ 1max=48A Material:Copper Thickness:1.0mm

ITEM NO.	d2 φ (mm)	Dimension(mm)						A.W.G mm <sup>2</sup>
		B	F	L	E	D φ	d φ	
HNB 5.5-3.5	3.7	9.5	9.5	19.8	6.0	5.6	3.4	12-10A.W.G 4-6mm <sup>2</sup>
HNB 5.5-4	4.3							
HNB 5.5-5	5.3							
HNB 5.5-6	6.4							
HNB 5.5-8	8.4	15.0	13.5	27.0				

■ 1max=62A Material:Copper Thickness:1.2mm

ITEM NO.	d2 φ (mm)	Dimension(mm)						A.W.G mm <sup>2</sup>
		B	F	L	E	D φ	d φ	
HNB 8-8	8.4	15.0	13.8	29.5	8.5	7.2	4.5	8A.W.G 8mm <sup>2</sup>

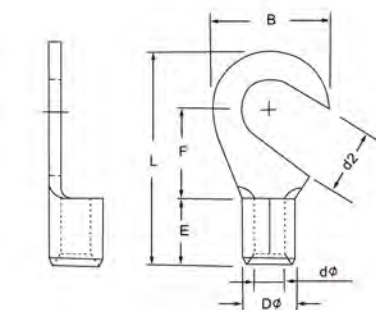

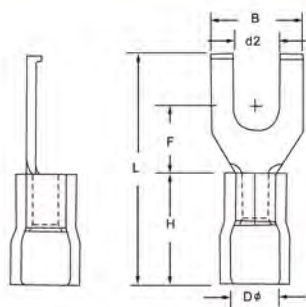

## 凸缘叉形预绝缘端头

## FLANGE SPADE VINYL-INSULATED TERMINAL

■ Conductor section: 0.5~1.5mm<sup>2</sup>(A.W.G22~16) 1max=19A Material: Copper Thickness: 0.75mm

ITEM NO.	American Bolt number	d2 φ (mm)	Dimension(mm)					Color
			B	L	F	H	D φ	
FSV 1.25-3.5	#6	3.7	7.5	19.0	5.1	10.0	4.3	Red
FSV 1.25-4	#8	4.3	7.5	19.0	5.1			
FSV 1.25-5	#10	5.3	7.5	19.0	5.1			

■ Conductor section: 1.5~2.5mm<sup>2</sup>(A.W.G16~14) 1max=27A Material: Copper Thickness: 0.8mm

ITEM NO.	American Bolt number	d2 φ (mm)	Dimension(mm)					Color
			B	L	F	H	D φ	
FSV 2-3.5	#6	3.7	7.5	19.0	5.2	10.0	4.9	Blue
FSV 2-4	#8	4.3	7.5	19.0	5.2			
FSV 2-5	#10	5.3	7.5	19.0	5.2			

■ Conductor section: 4~6mm<sup>2</sup>(A.W.G12~10) 1max=48A Material: Copper Thickness: 1.0mm

ITEM NO.	American Bolt number	d2 φ (mm)	Dimension(mm)					Color
			B	L	F	H	D φ	
FSV 5.5-3.5	#6	3.7	8.5	25.5	7.5	13.0	6.7	Yellow
FSV 5.5-4	#8	4.3	8.5	25.5	7.5			
FSV 5.5-5	#10	5.3	8.5	25.5	7.5			

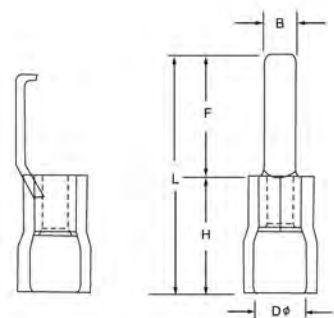

## 凹片形预绝缘端头

## LIPPED BLADE VINYL-INSULATED TERMINAL

■ Conductor section: 0.5~1.5mm<sup>2</sup>(A.W.G22~16) 1max=19A Material: Copper Thickness: 0.75mm

ITEM NO.	Dimension(mm)					Color
	B	L	F	H	D φ	
LBV 1.25-3	3.0	26.8	16.8	10.0	4.3	Red
LBV 1.25-4.6	4.6	26.8	16.8			

■ Conductor section: 1.5~2.5mm<sup>2</sup>(A.W.G16~14) 1max=27A Material: Copper Thickness: 0.8mm

ITEM NO.	Dimension(mm)					Color
	B	L	F	H	D φ	
LBV 2-3	3.0	26.8	16.8	10.0	4.9	Blue
LBV 2-4.6	4.6	26.8	16.8			

■ Conductor section: 4~6mm<sup>2</sup>(A.W.G12~10) 1max=48A Material: Copper Thickness: 1.0mm

ITEM NO.	Dimension(mm)					Color
	B	L	F	H	D φ	
LBV 5.5-3	3.0	29.3	16.8	13.0	6.7	Yellow
LBV 5.5-4.6	4.6	29.3	16.8			



**长形全绝缘中间接头(尼龙)**

**LONG FULL INSULATING MIDDLE JOINT(NYLON)**

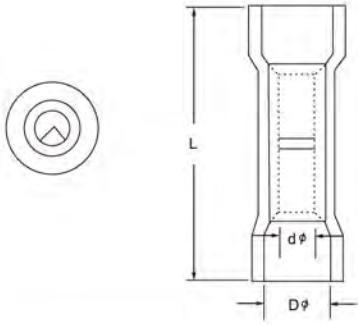

- $I_{max}=26-22$  A.W.G:9A     $22-16A$ .W.G:19A  
      $16-14$  A.W.G:27A     $12-10A$ .W.G:48A

Max withstanding pressure:105℃ 600V Insulating Cover Material:Nylon

ITEM NO.	Dimension(mm)			Joint material	A.W.G mm <sup>2</sup>	Color
	L	D φ	d φ			
BNY 1.25	27.3	3.2	1.7	Copper	22-16A.W.G 0.5-1.5mm <sup>2</sup>	Red
BNY 2	27.3	3.8	2.3	Copper	16-14A.W.G 1.5-2.5mm <sup>2</sup>	Blue
BNY 5.5	27.3	5.3	3.4	Copper	12-10A.W.G 4-6mm <sup>2</sup>	Yellow

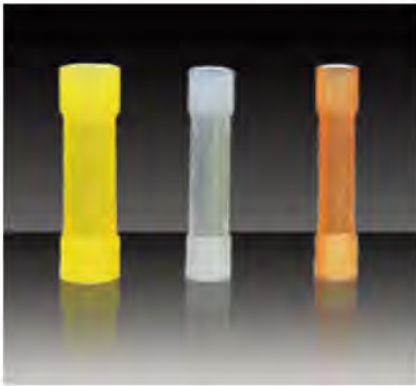

**旗形母绝缘接头(尼龙)**

**FLAG FEMALE INSULATING JOINT(NYLON)**

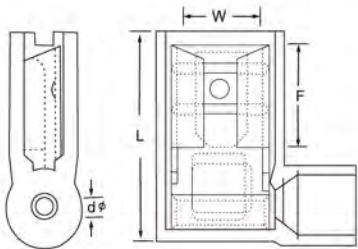

- $I_{max}=22-18$  A.W.G:10A     $16-14$  A.W.G:15A     $12-10$  A.W.G:24A

Max withstanding pressure:105℃ 600V

Material:Brass Insulating Cover Material:Nylon

Thickness:0.4mm

ITEM NO.	connect specification	Dimension(mm)				A.W.G mm <sup>2</sup>
		W	F	L	d φ	
FLDNY 1.25-250	0.8 × 6.35	6.6	7.6	16.0	17	22-18A.W.G 0.5-1.5mm <sup>2</sup>
FLDNY 2-250	0.8 × 6.35	6.6	7.6	16.0	17	16-14A.W.G 1.5-2.5mm <sup>2</sup>
FLDNY 5.5-250	0.8 × 6.35	6.6	7.6	16.0	17	12-10A.W.G 4-6mm <sup>2</sup>

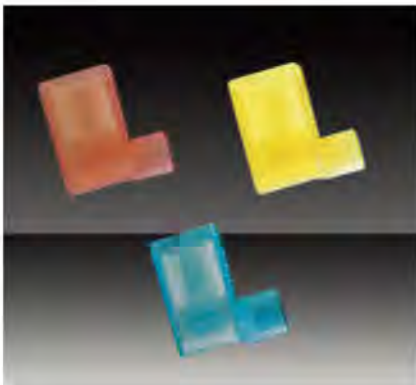

## 公、母全绝缘接头(尼龙)

## MALE AND FEMALE FULL-INSULATING JOINT(NYLON)

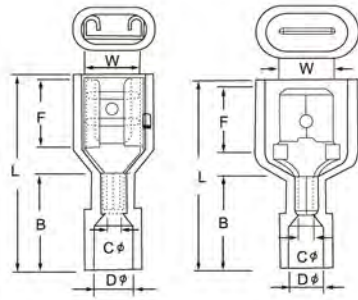

## ■ 1max=10A Material:Brass Insulating Cover Material:Nylon

ITEM NO.	connect specification	Dimension(mm)							Fig	A.W.G mm <sup>2</sup>	Color
		W	F	L	B	Dφ	Cφ	T			
FDNF 1.25-250	0.8 × 6.35	6.6	7.3	22.0	11.0	4.0	1.7	0.4	1	22-16 A.W.G	Red
MDFN 1.25-250		6.35	7.7	23.0					2	0.5-1.5 mm <sup>2</sup>	

## ■ 1max=15A Material:Brass Insulating Cover Material:Nylon

ITEM NO.	connect specification	Dimension(mm)							Fig	A.W.G mm <sup>2</sup>	Color
		W	F	L	B	Dφ	Cφ	T			
FDNF 2-250	0.8 × 6.35	6.6	7.3	22.0	11.0	4.5	2.3	0.4	1	16-14 A.W.G	Blue
MDFN 2-250		6.35	7.7	24.0					2	1.5-2.5 mm <sup>2</sup>	

## ■ 1max=24A Material:Brass Insulating Cover Material:Nylon

ITEM NO.	connect specification	Dimension(mm)							Fig	A.W.G mm <sup>2</sup>	Color
		W	F	L	B	Dφ	Cφ	T			
FDNF 5.5-250	0.8 × 6.35	6.6	7.3	24.0	13.0	6.3	3.4	0.4	1	12-10 A.W.G	Yellow
MDFN 5.5-250		6.35	7.7	25.0					2	4-6 mm <sup>2</sup>	



## 公、母全绝缘接头(尼龙)

## MALE AND FEMALE FULL-INSULATING JOINT(NYLON)

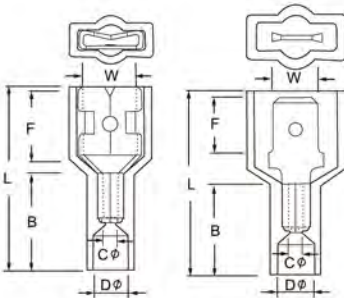

## ■ 1max=10A Material:Brass Insulating Cover Material:Nylon

ITEM NO.	connect specification	Dimension(mm)							Fig	A.W.G mm <sup>2</sup>	Color
		W	F	L	B	Dφ	Cφ	T			
FDNFY 1.25-250	0.8 × 6.35	6.6	7.3	22.0	12.0	4.0	1.7	0.45	1	22-16 A.W.G	Red
MDFNY 1.25-250		6.35	7.7	23.0					11.0	4.0	

## ■ 1max=15A Material:Brass Insulating Cover Material:Nylon

ITEM NO.	connect specification	Dimension(mm)							Fig	A.W.G mm <sup>2</sup>	Color
		W	F	L	B	Dφ	Cφ	T			
FDNFY 2-250	0.8 × 6.35	6.6	7.3	23.0	12.0	4.5	2.3	0.45	1	16-14 A.W.G	Blue
MDFNY 2-250		6.35	7.7	24.0					11.0	4.5	

## ■ 1max=24A Material:Brass Insulating Cover Material:Nylon

ITEM NO.	connect specification	Dimension(mm)							Fig	A.W.G mm <sup>2</sup>	Color
		W	F	L	B	Dφ	Cφ	T			
FDNFY 5.5-250	0.8 × 6.35	6.6	7.3	23.0	12.0	5.0	3.4	0.45	1	12-10 A.W.G	Yellow
MDFNY 5.5-250		6.35	7.7	24.0					11.0	5.0	



**绝缘软套管**

**PVC INSULATED TERMINAL SLEEVE**

■ Material:PVC(助燃不褪色)多种颜色

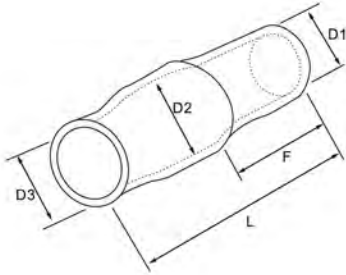

ITEM NO.	Dimension(mm)				
	D1	D2	D3	L	F
V 1.25	2.8	3.3	3.1	13.0	7.0
V 2	3.3	4.5	3.7	15.0	7.0
V 3.5	4.2	5.7	4.1	20.0	8.0
V 5.5	4.8	5.7	5.2	20.0	8.0
V 8	6.2	7.2	6.2	20.0	9.0
V 14	7.5	10.0	8.0	27.0	11.0
V 22	10.5	12.0	9.5	30.0	15.0
V 38	12.5	14.0	11.8	36.0	16.5
V 60	15.0	16.8	13.5	39.0	19.0
V 70	16.0	17.5	14.5	43.0	20.0
V 80	17.0	19.0	16.0	47.0	22.0
V 100	19.0	22.0	18.0	54.0	24.0
V 125	21.0	24.0	20.0	57.0	25.0
V 150	23.0	24.5	22.0	65.0	30.0
V 200	27.0	32.0	24.0	65.0	30.0
V 240	29.0	38.0	26.0	77.0	39.0
V 325	29.0	38.0	29.0	77.0	40.0
V 400	42.0	45.0	36.0	85.0	41.0
V 500	46.0	48.0	40.0	88.0	42.0
V 630	52.0	54.0	44.0	92.0	47.0



## OPEN BARREL TERMINALS(FEMALE &amp; MALE)



ITEM NO.	METAL	WIRE RANGE	Dimension(mm)			THICKNESS
			D	W	E	
Y 3-2.5	Brass	0.5-2.5	3.2			0.6
DJ 431-3A		0.5-0.8	3.5	9.0	17.0	0.5
DJ 431-5A		0.5-0.8	5.2	10.0	17.0	0.5
DJ 431-6A		0.5-0.8	6.2	12.0	17.0	0.5
DJ 431-8B		1.0-1.5	8.2	15.0	17.0	0.8
DJ 431-10B		1.0-1.5	10.5	19.0	19.0	0.8

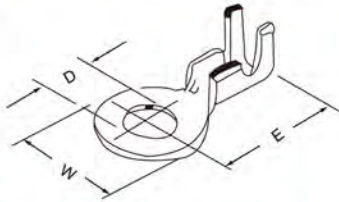
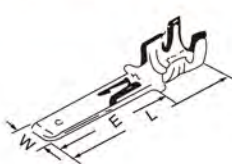
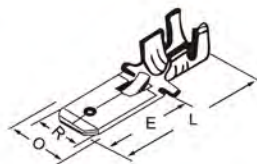

Fig	ITEM NO.	METAL	WIRE RANGE	Dimension(mm)				THICKNESS
				D	W	L	E	
A	DJ611-2.8 × 0.5B	Brass	1.0-1.5	/	2.8	21.0	12.0	0.5
B	DJ611-6.3A		0.5-0.8	7.9	6.3	25.0	13.8	0.4
B	DJ611-6.3B		1.0-1.5	7.9	6.3	25.0	13.8	0.4
B	DJ612-6.3C		2.0-2.5	7.9	6.3	25.0	13.8	0.4
C	DJ617-6.3B		1.0-1.5	/	6.3	19.2	/	0.4



A



B

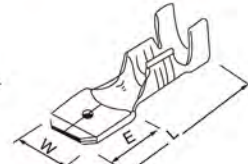

C



Fig	ITEM NO.	METAL	WIRE RANGE	Dimension(mm)			THICKNESS
				W	L	E	
A	DJ621-E2.8 × 0.5B	Brass	1.0-1.5	4.1	16.0	6.6	0.3
A	DJ621-D2.8 × 0.5A		0.5-0.8	3.7	15.1	6.3	0.25
A	DJ621-E2.8 × 0.5A		0.5-0.8	6.0	13.8		0.3
B	DJ625-4.8 × 0.8A		0.5-0.8	6.4	12.0	6.2	0.4
C	DJ621-5A		0.5-0.8	5.2	17	5.5	0.3
C	DJ611-5B		1.0-1.5	5.2	17	5.5	0.3
D	DJ622-A6.3B		1.0-1.5	7.7	18.5	7.5	0.4
E	DJ622-D6.3B		1.0-1.5	7.7	17.5	7.5	0.4

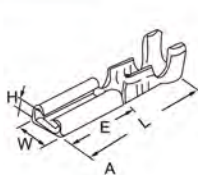

A

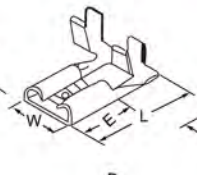

B

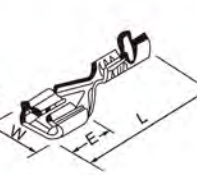

C

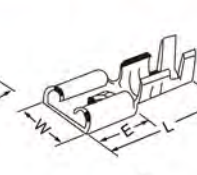

D

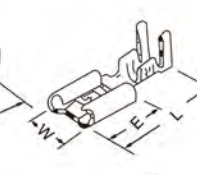

E

**OPEN BARREL TERMINALS(FEMALE & MALE)**



Fig	ITEM NO.	METAL	WIRE RANGE	Dimension(mm)					THICKNESS
				D	H	W	L	E	
A	DJ211-3.5B	Brass	1.0-1.5			3.5	15.0		0.5
A	DJ211-4B		1.0-1.5			4.0	16.0		0.5
B	DJ221-2.3B		1.0-1.5			3.9	19.0	7.4	0.3
B	DJ221-3.5B		1.0-1.5			3.3	17.6	6.5	0.3
B	DJ221-4B		1.0-1.5			3.8	17.6	6.5	0.4

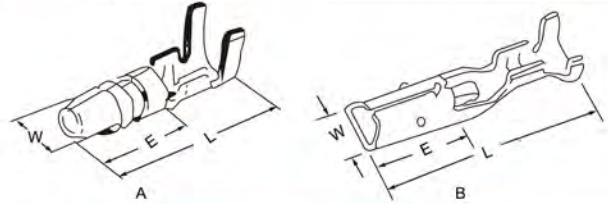

**TERMINALS BLOCKS**

■ **TERMINAL BLOCKS H,U(W),V(F)TYPE**

Material:made from PA,PE or PP.

Application

H.F.W.Series terminal connectors are used in the circuits of AC.50Hz or 60Hz voltage up to 660V or DC.Volitage up to 440V current from 3A to 150A,for connecting the round copper conductors.

Specification

ITEM NO.	L	A	H	M	B	mm <sup>2</sup>	VOLT	AMP	PACKING
DL-3A	93	16	12	6	8	4	400V	3A	10PCS
DL-6A	115	15.7	13	6.5	9.5	6	400V	6A	
DL-10A	126	20.2	15.5	8.4	10.5	10	400V	10A	
DL-16A	139	23	17.7	10.3	12	12	400V	16A	
DL-20A	155	25	19.2	11.5	13.5	14	400V	20A	
DL-30A	171	26	20.5	12	14.5	16	400V	30A	
DL-60A	192	30	26	13.5	16.5	25	400V	60A	
DL-80A	205	33	27	15	17	35	400V	80A	
DL-100A	250	46	31	22	21	40	400V	100A	

